



CUSTOM DESIGNED & QUALITY BUILT
HOMES • ADDITIONS

Tender Loving Care that puts YOU first!

Description:

- 27'6" x 48'6"
- 2971 sqft & 2 car garage
- 3 Bedrooms, 2 1/2 baths
- Large Master Suite
- Tray ceiling in Dining Room
- 9' first floor
- Open Foyer
- Great Room
- Ample storage

Hebron Colonial

Photograph may differ from floor plan

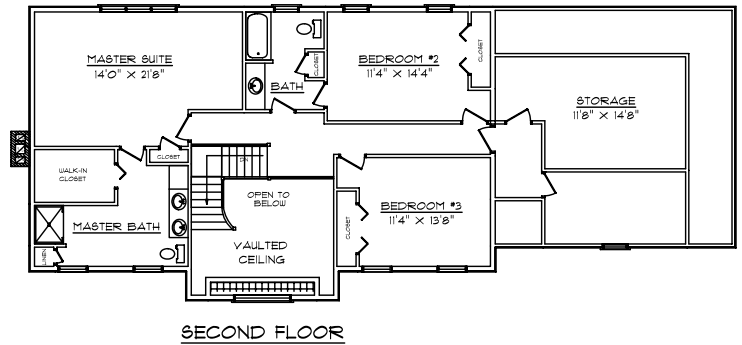
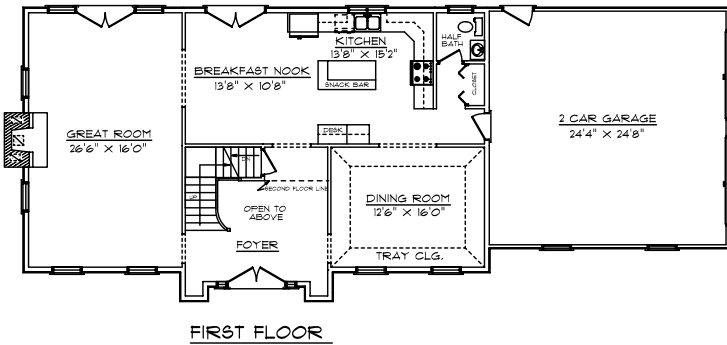

Cost:

Advertised Erected Shell:	\$ 109,840.00*
Sub-Contracting Estimates:	\$ 117,290.00**
Excavation/Septic/Sewer/Well/Water:	\$ <u>Variables not known</u>⁺
 Total Cost:	 \$ 227,130.00⁺⁺

Cost Per Square Foot (House/Garage): \$ 76.45

* Includes blueprints, materials & labor.

** Items included in Sub-Contracting Estimate: Foundation, concrete floors, hatchway & stoop(s), fireplace/masonry, plumbing, heating, electrical (NEC), insulation, gutters & leaders, sheetrock, interior package (cabinets/vanities/trim/doors), interior package labor, finished stairs, finished floors, permits, lighting fixtures (interior & exterior).

+ Items **NOT** included in Estimate: Land, excavation, septic or sewer hook-up, well or water hook-up, surveying/engineering, foundation damp-proofing, basement & garage grading, painting/staining (interior & exterior), appliances, clean-up at job site, landscaping, driveway (gravel & apron), miscellaneous decorating.

⁺⁺ Prices may vary with location & may change without notice due to economic variables.